

USING *Shadefix* WITHOUT THE COVER STRIP

1. Draw a guideline 15mm around the inside of the frame. (Figure 3)
2. Place *Shadefix* strip along this line. (Figure 3)
3. Nail *Shadefix* continuously around all 4 sides, using every second elongated hole.
4. Fit shadecloth as per Figure 1.

Important: It is recommended that *Shadefix* coverstrip be used; or hammer the fixing points down after installation, if there is any risk of injury.

FIGURE 3

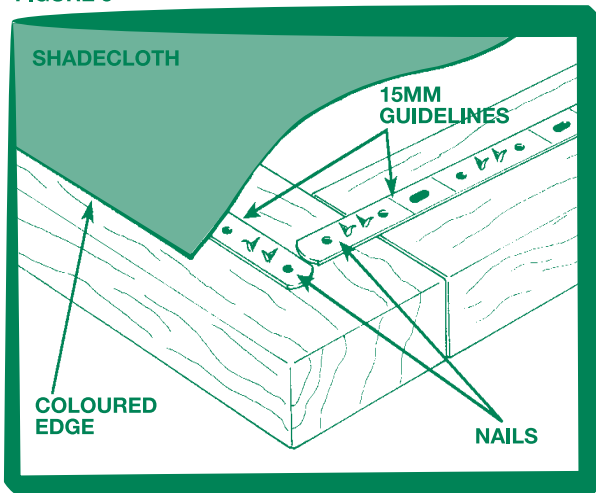

- Enclose decks, verandahs, entertainment areas.
- Easy to install and re-use year after year
- Saves you money and lasts longer
- For a professional finish to a shadecloth installation
- One person Installation

QUICK INSTALLATION OF *Shadefix*

● COVER STRIP ● BASE STRIP ○ METAL INSERT ● SHADECLOTH

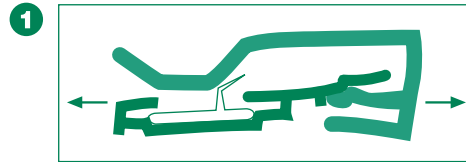

1 Separate the two pvc strips.

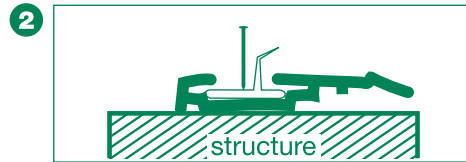

2 Attach to structure.

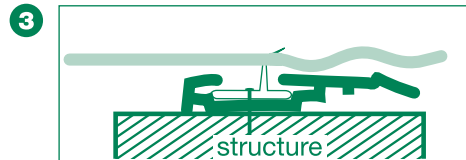

3 Tension the shadecloth over the base strip.

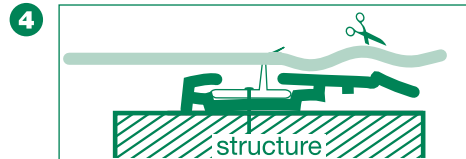

4 Trim excess cloth.

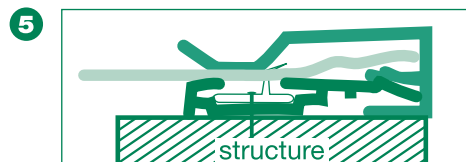

5 Fix cover strip firmly in place.

HINTS

1. Don't over tension shadecloth.
2. If the weave becomes distorted, it's too tight.
3. To shorten - hold the metal strip with pliers at the desired length - and bend/break off excess.
4. When joining sections of the cover strip, offset the joints of the top and bottom sections.

Shadefix

SHADECLOTH FASTENER

INSTALLATION INSTRUCTIONS SEE INSIDE

INSTALLING SHADECLOTH

Shadecloth is manufactured with a coloured edge - **always start with this side.**

1. Spread the shadecloth loosely over the area to be covered. Then hook it onto the *Shadefix* strip at intervals to keep the shadecloth in place temporarily.
2. Starting at the centre point A, hook the coloured edge 150mm (6 inches) either side of A. Use a slight sideways tension to remove slack. Leave an excess of 20mm.
3. Then go to point B. Pull the shadecloth over the *Shadefix* strip - then release it under a suitable tension onto the fixing points.
4. Using the lines in the pattern of the shadecloth as a guide attach it evenly - moving out.
5. Repeat 3 and 4 on the remaining sides. Adjust as necessary for even tension.
6. Trim the excess shadecloth to the edge of the bottom section of the cover strip.

FIGURE 1

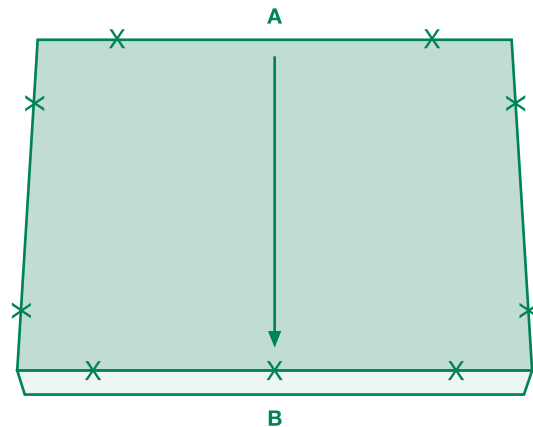

INSTALLING *Shadefix* COVER STRIP

1. Draw a guideline 10mm (1/2 inch) from the inside of the frame (line A).
2. Draw guidelines as extensions of the inside edges of the frame at the corners (line B).
3. Place the bottom sections (including metal strip) along line A starting from line B.
4. Ensure the tongue and fixing points face outwards or away from the shadecloth area.
5. Nail the bottom sections (including the metal strip) every 150mm (6 inches) using the holes punched in the metal strip.
6. Extend the lines of the outer edges of the bottom sections. These lines will intersect at point C.

FIGURE 2

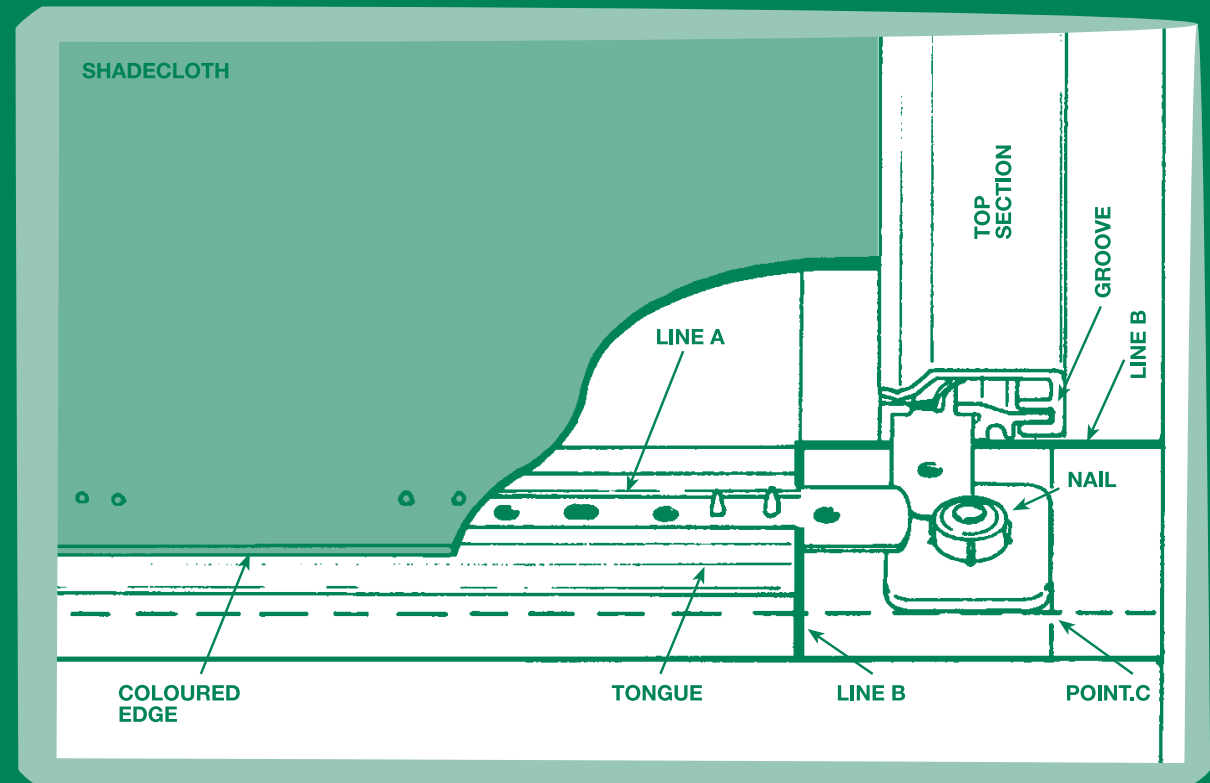

7. After fixing your shadecloth as per Figure 1, trim to the edge of the bottom section.
 8. Align top and bottom sections, then seat the tongue of the bottom section into the track of the top section. Press and click into place - slightly lifting the inner edge over the fixing points.
 9. Position the corner button at point C and nail it into place.
 10. Clip the corner piece onto the button.
- Corners exactly as per Figure 2